

Exe Valley Rotary Extend Gratitude to Promap for the Provision of the Ordnance Survey Map & Linked GeoTIFF Aerial Photograph as their Sponsorship Contribution Towards the Uffculme Show & County Fair 2021

- SYMBOLS KEY**
- Powder Type Fire Extinguisher
 - Foam Type Fire Extinguisher
 - Water Type Fire Extinguisher
 - Standard Self-Contained Mobile MC Unit
 - Inclusive Self-Contained Mobile MC Unit Suitable for Use by Persons with Impaired Mobility

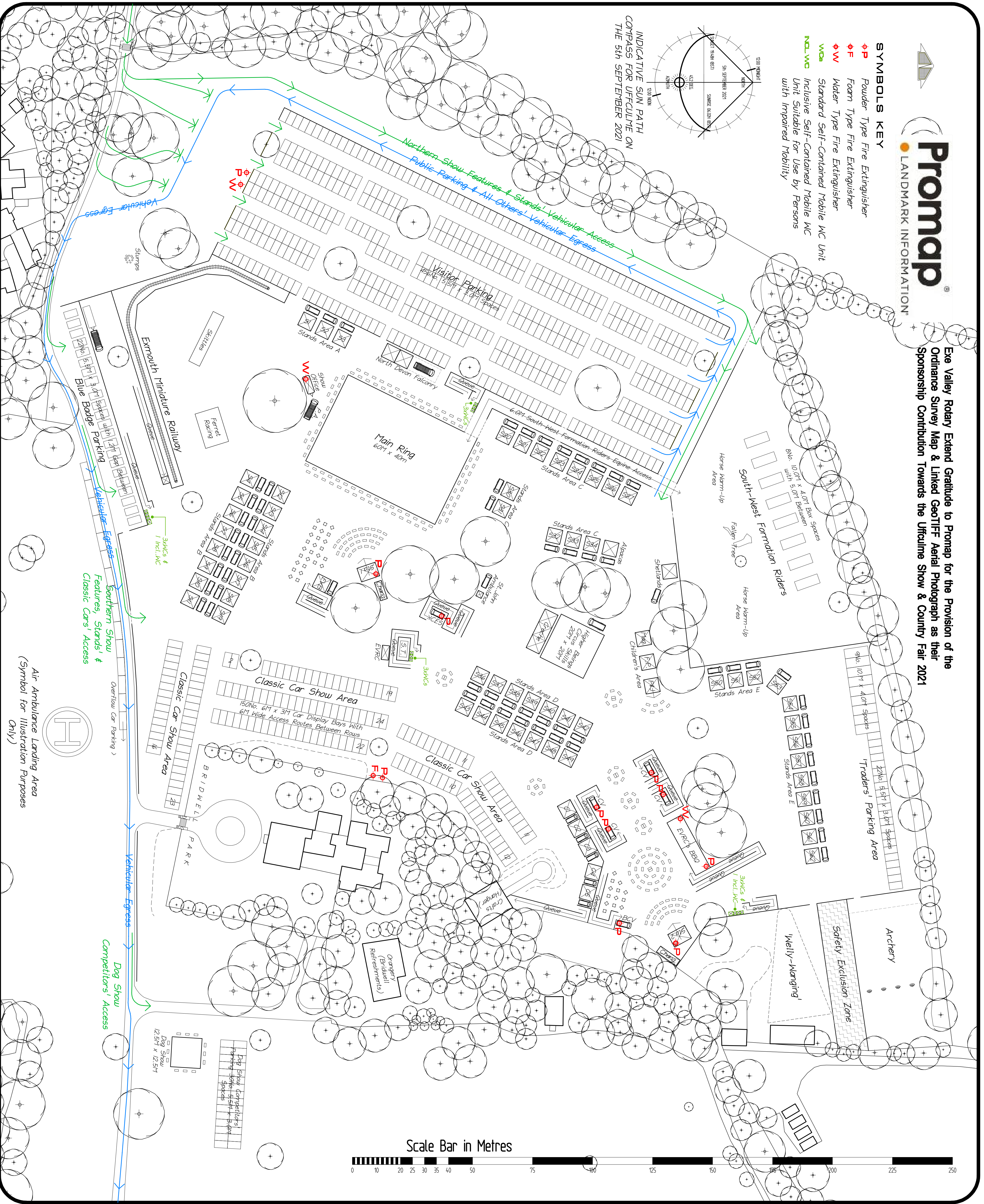
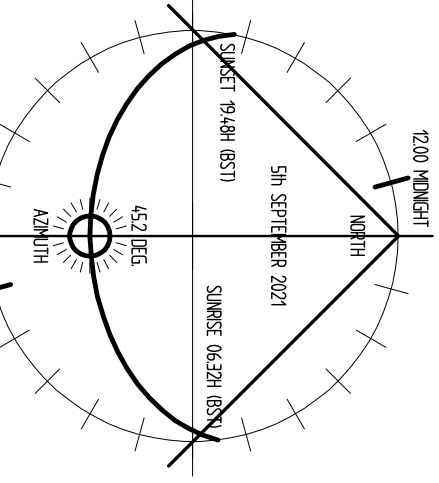

Scale Bar in Metres

AMENDMENTS

A 27/06/21 Revisions following group meeting on 26/06/21

GENERAL NOTES

- 01 Do not scale
- 02 This drawing is subject to strict copyright and may not be reproduced without written consent
- 03 Based on the Ordnance Survey map with the permission of the Controller of Her Majesty's Stationery Office. Crown copyright reserved. Berry Associates OS Licence No. 70005789
- 04 If in doubt > Ask!



**EXE VALLEY
ROTARY**



BRIDWELL PARK

HIGH RISK HEALTH & SAFETY MATTERS
VEHICULAR MOVEMENTS DURING SET-UP ON THE SHOW DAY & CLEARING OPERATIONS, CARBON MONOXIDE & FIRE RISK FROM GENERATORS & COOKING ARE TO BE CONSIDERED HIGH RISK HEALTH & SAFETY ELEMENTS AS ADDRESSED WITHIN THE ORGANISERS' RISK ASSESSMENTS

BERRY ASSOCIATES
PLANNING - ARCHITECTURE - CIVIL
TELEPHONE & FACSIMILE 01884 880007
PROJECT

Uffculme Show & County Fair 2021 at Bridwell Park, Uffculme, Devon
for
Exe Valley Rotary Club

TITLE
Proposed Show Layout - Issue 1

DATE
June 2021

SCALE
A1 > 1 - 750

DRAWN BY
Garry J. Berry

DRAWING NUMBER
UFF.SHOW 2021/03

Air Ambulance Landing Area
(Symbol for Illustration Purposes Only)